

# CM3000

## Networked Audio Controller

Modern schools utilize audio to communicate with faculty, students and others throughout the school day, for a wide range of instructional and administrative purposes. Efficient management of audio sources and destinations is fundamental to school operations. Just as the diversity and importance of audio in schools has grown, the emergence of robust school networks, classroom AV systems and affordable streaming technologies is creating new opportunities for convergence.

The CM3000 is integrated networked audio controller that simplifies the distribution and management of classroom and school-wide audio. Included in the CM3000 are a:

- 4 input, 32-watt amplifier
- Networked classroom A/V controller
- IP audio encoder/decoder
- 4 port 10/100 switch
- RS 232 and IR control outputs

A versatile classroom tool, the CM3000 will increase audio performance, classroom control and extend your IT budget. For example, when it's paired with FrontRow's WCM-RF classroom voice amplification system, the CM3000 will allow for convenient control of all classroom audio sources. Also, RS 232 and IR control outputs allows for networked control over typically non-networked devices like projectors and DVD players. The inclusion of a 4 port 10/100 switch eliminates the need for an additional network drop and reduces the amount of network cable required in the classroom.

As part of FrontRow's integrated School Communication Solution, the CM3000 can be deployed at the head-end, in classrooms, hallways, and other common areas. It provides efficient school-wide audio by converting analog to IP audio for network streaming and IP audio back to analog for listening. The built-in 4-input, 32-watt amplifier provides high-quality audio to the classroom. Network based classroom AV device control makes it easy for teachers to use various audio sources for instruction. In addition, the CM3000 auto-detects audio source priority and adjusts sound levels to, for example, prioritize an emergency alert message.



### Key Benefits

- Networked streaming/analog audio to classrooms and school common areas
- High-quality school-wide audio
- Auto-detect and mute for priority audio alerts
- Network based classroom AV control
- Network control over non-networked devices like projectors and DVD
- Reduced installation and on-going maintenance costs

### Key Components

- IP audio encoder/decoder
- 4 input analog, 32W, amplifier/switcher
- Network based classroom AV controller
- 4 port 10/100 switch
- RS 232 and IR control outputs

## CM3000 Setup

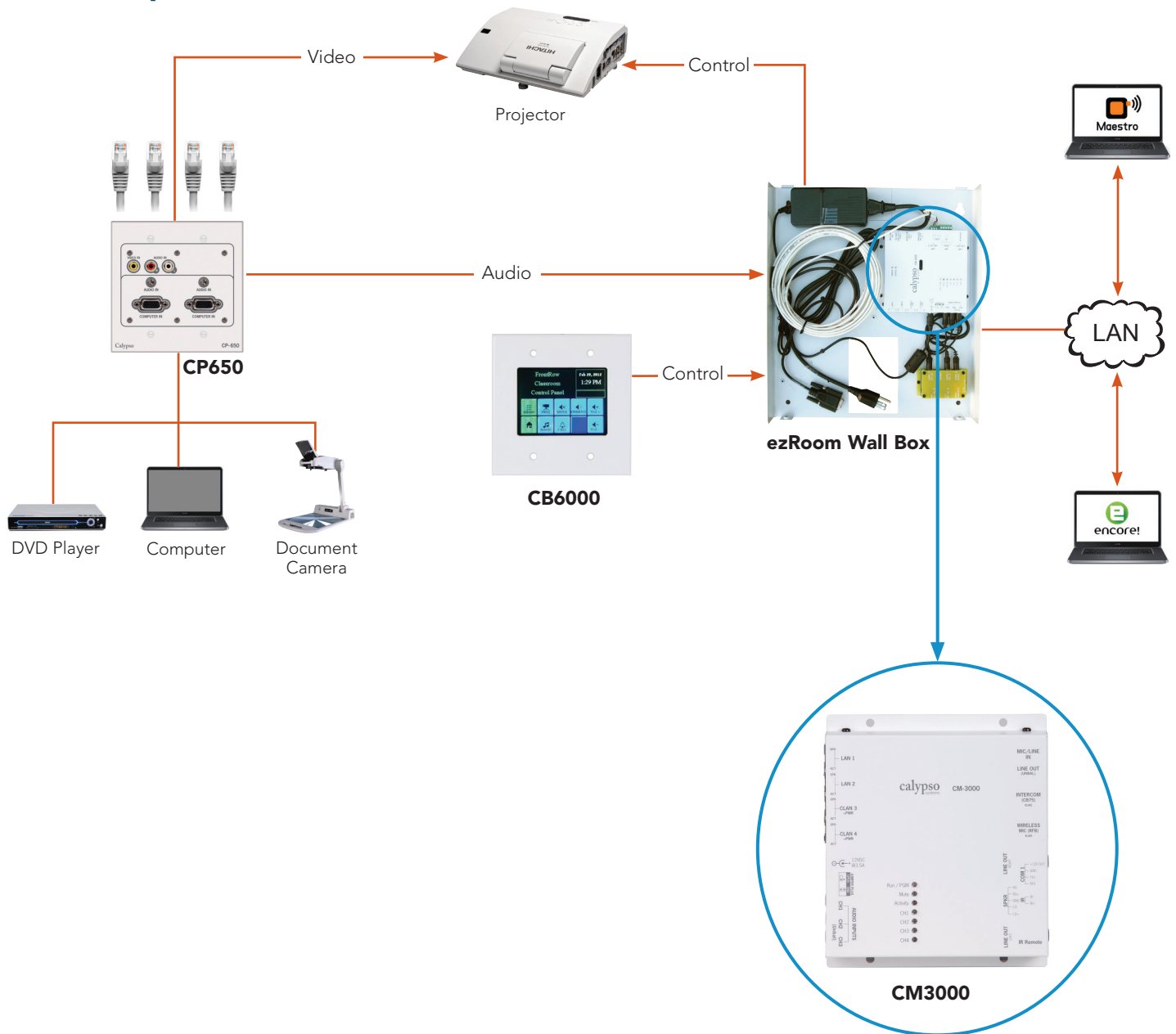

## Specifications

**Network support:** 10/100Mb/s (auto sensing)

**Serial Baud rate:** 2400 to 57600 baud

**Amplifier type:** Class D

**Frequency response:** 20Hz to 20kHz

**Signal-to-noise:** >84 dB @ 20 Hz to 20 kHz at maximum output (unweighted, with balanced input)

**THD:** 0.1% @ 1kHz, at nominal level (1 watt, 8 ohm load)

**Maximum audio output power:** 2 x 8w (8Ω), 2 x 16w (4Ω)

**Power supply:** 12VDC at 3.5A

**Size (WxHxD):** 13 x 14.9 x 2.86cm/5.125 x 5.875 x 1.125in

**Weight:** 0.35kg/0.77lbs

### INPUTS/OUTPUTS

- Input power jack
- (4) RJ45 network jacks (2 supplying 12VDC to power control panels)
- (2) 3.5mm unbalanced inputs and (1) 3.5mm configurable balanced/unbalanced input
- (1) RJ45 mic input jack
- (1) RJ45 intercom input jack
- (3) 3.5mm audio output jacks (2 balanced, 1 unbalanced)
- (1) captive screw loudspeaker terminal left and right (mono output)
- (1) captive screw IR control terminal
- (1) captive screw serial control terminal